

Instructions for Premium Plus Remote for Android & iOS tablets & smartphones

Video Instruction: https://youtu.be/Y6DE_P0DgsE



1) Bring the VR glasses into the Wi-Fi

- In the main menu, click on the Wi-Fi symbol with the green laser beam at the bottom left

Wi-Fi



- In the Wi-Fi menu, enter the Wi-Fi password on the virtual keyboard and press “Connect”

Password

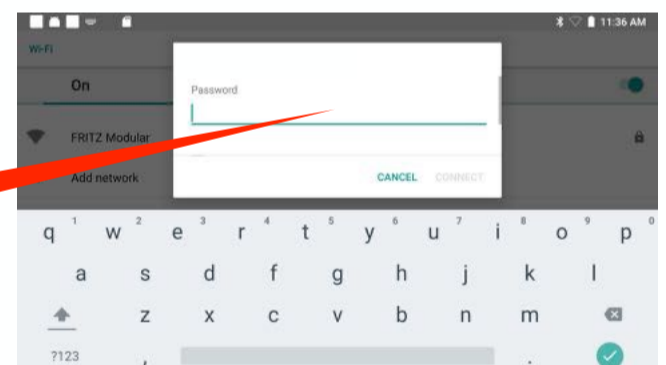

2) Bring the tablet or smartphone into the same Wi-Fi

- Enter the Wi-Fi password in the tablet under “Settings” under “Network & Internet”

Wi-Fi



Alternatively, you can set up a hotspot with your smartphone and connect the VR glasses to this hotspot

3) Download the P+ Remote App from the App Stores:

Android



[download from Google Play Store](#)

iOS



[download from Apple Store](#)

4) On the tablet or smartphone

- Start the P+ Remote App

P+ Remote App

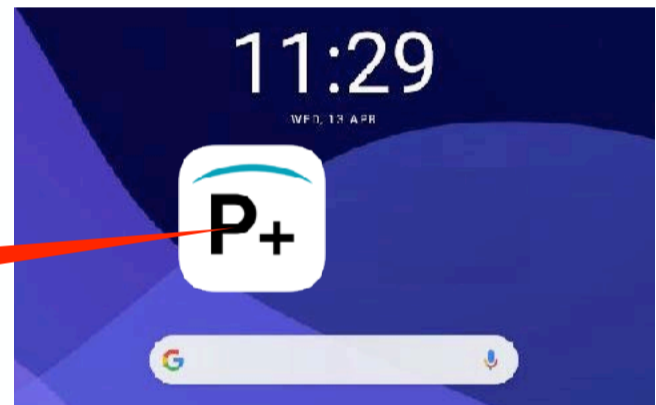

- Click on the flashing Wi-Fi icon to connect

Connect

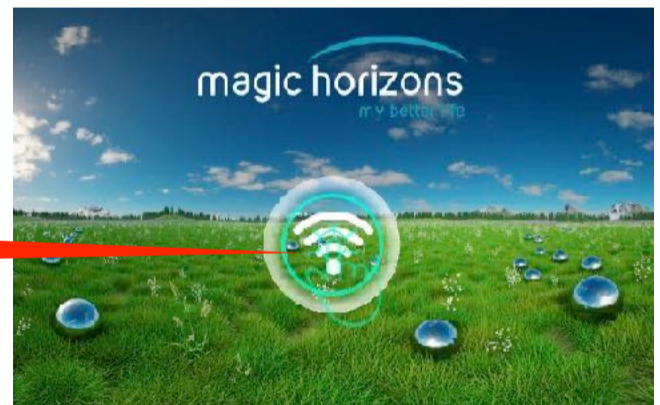

5) In the VR glasses

- Click on the „connect“ **chain-icon** with the green laser beam
- The VR glasses are connecting automatically

Connect

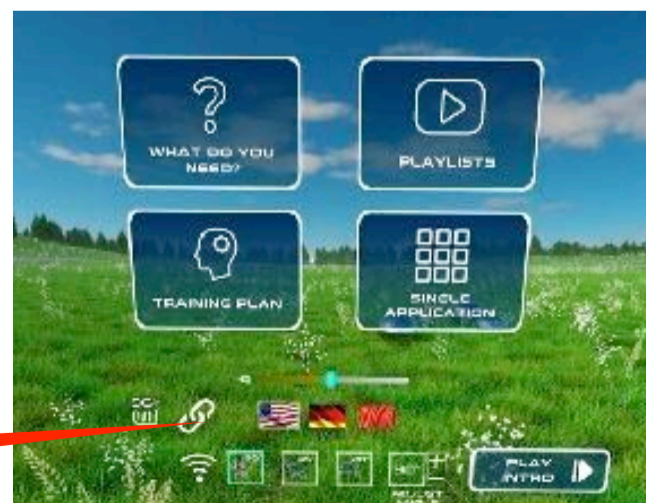

Important for Apple iOS devices:

- When you open the P+ app for the first time, a message appears:
- „P+ Remote would like to connect devices on your local network“
- Click on "**Allow**" – otherwise the P+ app will not work.
- Then **close** the P+ app on the iOS device and **restart** the P+ app again.

6) On the tablet or Smartphone

- You can connect up to 10 VR glasses depending on your local Wi-Fi speed
- You see an **orange** number for each connected VR glass
- When all VR glasses are connected press „All VR glasses registered“

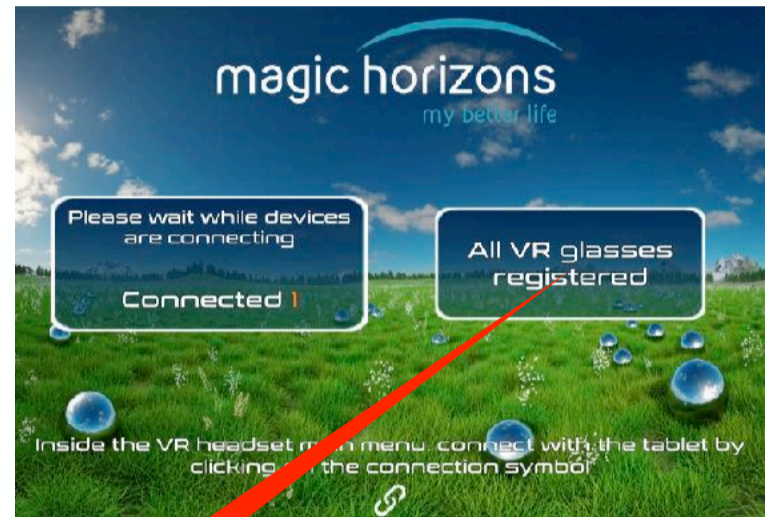

Connect

**The VR glasses and tablet or smartphone are now connected.
The VR glasses are now controlled by the tablet or smartphone.**

7) Tablet operation

- In the tablet main menu, you can choose between the Trailer, the Playlists and the Single Application, set the language, volume and the sitting/lying position

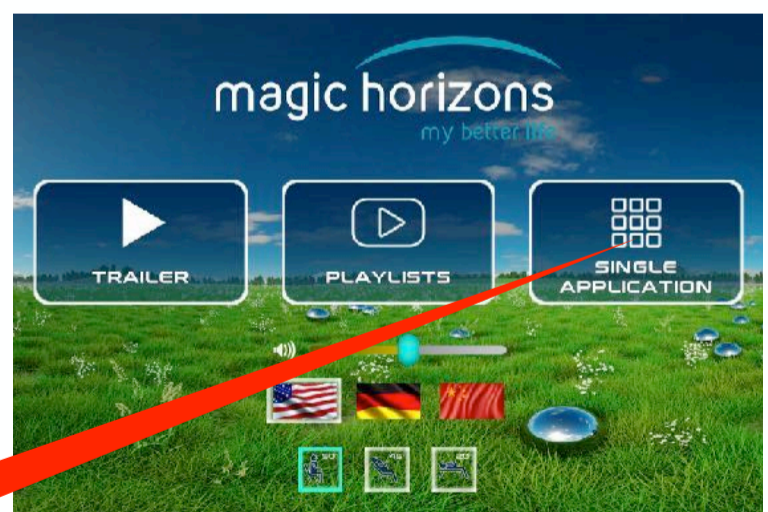

Single application

- The individual VR applications are started in the Single Application menu
- Use the white arrows to scroll to more VR applications
- Clicking on the white door symbol at the bottom takes you back to the main menu



- After clicking on a VR application, it starts and you are in the playback menu
- There you can adjust the volume, pause, see a video that shows what is happening in the VR glasses and see the remaining time
- If multiple VR glasses are connected you can switch between them by clicking on the VR head symbol
- Clicking on the "X" symbol ends the running VR application and you are back in the Single Application menu

